

**SCENARIO 1**

- SINGLE FUNCTION
- MAX. 300 PEOPLE
- KITCHEN AND BAR ACCESS
- DIRECT TOILET ACCESS
- ENTRY FROM 3 SIDES

**SCENARIO 2**

- 2 CONCURRENT FUNCTIONS
- FUNCTION 1
  - MAX. 198 PEOPLE
  - NO KITCHEN OR BAR ACCESS
  - TOILET ACCESS VIA EXTERNAL VERANDA
  - ENTRY FROM SOUTH AND EAST
- FUNCTION 2
  - MAX. 102 PEOPLE
  - KITCHEN AND BAR ACCESS
  - DIRECT TOILET ACCESS
  - ENTRY FROM NORTH AND EAST

**SCENARIO 3**

- 2 CONCURRENT FUNCTIONS
- FUNCTION 1
  - MAX. 102 PEOPLE
  - BAR ACCESS
  - NO KITCHEN ACCESS
  - TOILET ACCESS VIA EXTERNAL VERANDA
  - ENTRY FROM SOUTH AND EAST
- FUNCTION 2
  - MAX. 198 PEOPLE
  - KITCHEN ACCESS
  - NO BAR ACCESS
  - DIRECT TOILET ACCESS
  - ENTRY FROM NORTH AND EAST

**SCENARIO 4**

- 3 CONCURRENT FUNCTIONS
- FUNCTION 1
  - MAX. 102 PEOPLE
  - BAR AND KITCHEN ACCESS
  - TOILET ACCESS VIA EXTERNAL VERANDA
  - ENTRY FROM SOUTH AND EAST
- FUNCTION 2
  - MAX. 95 PEOPLE
  - NO KITCHEN AND BAR ACCESS
  - TOILET ACCESS VIA EXTERNAL VERANDA
  - ENTRY FROM EAST
- FUNCTION 3
  - MAX. 102 PEOPLE
  - KITCHEN AND BAR ACCESS
  - DIRECT TOILET ACCESS
  - ENTRY FROM NORTH AND EAST

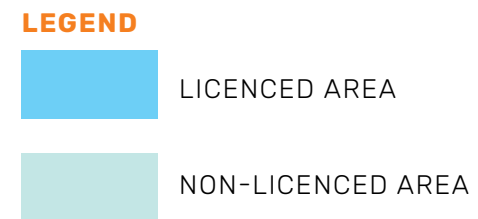
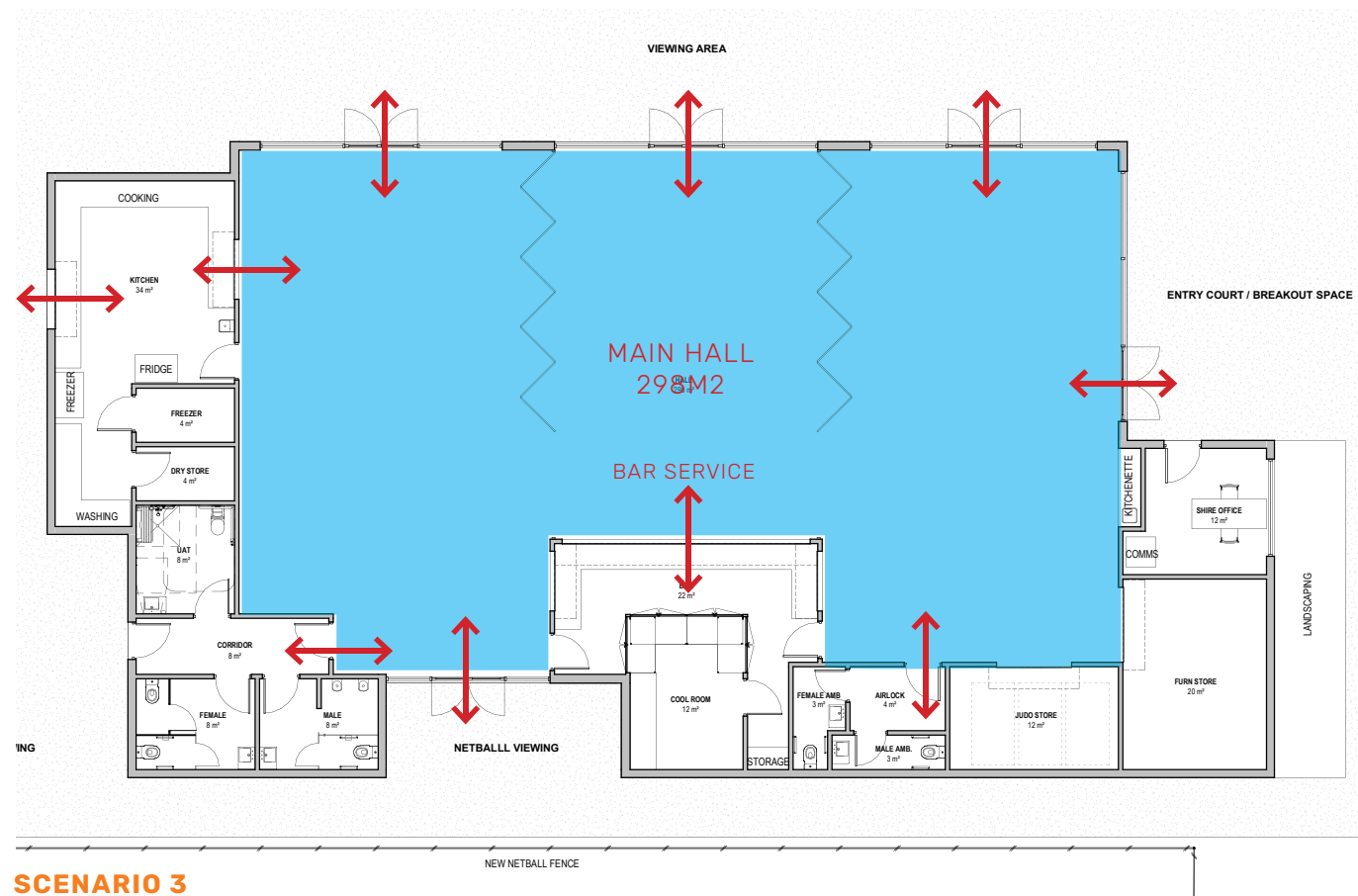
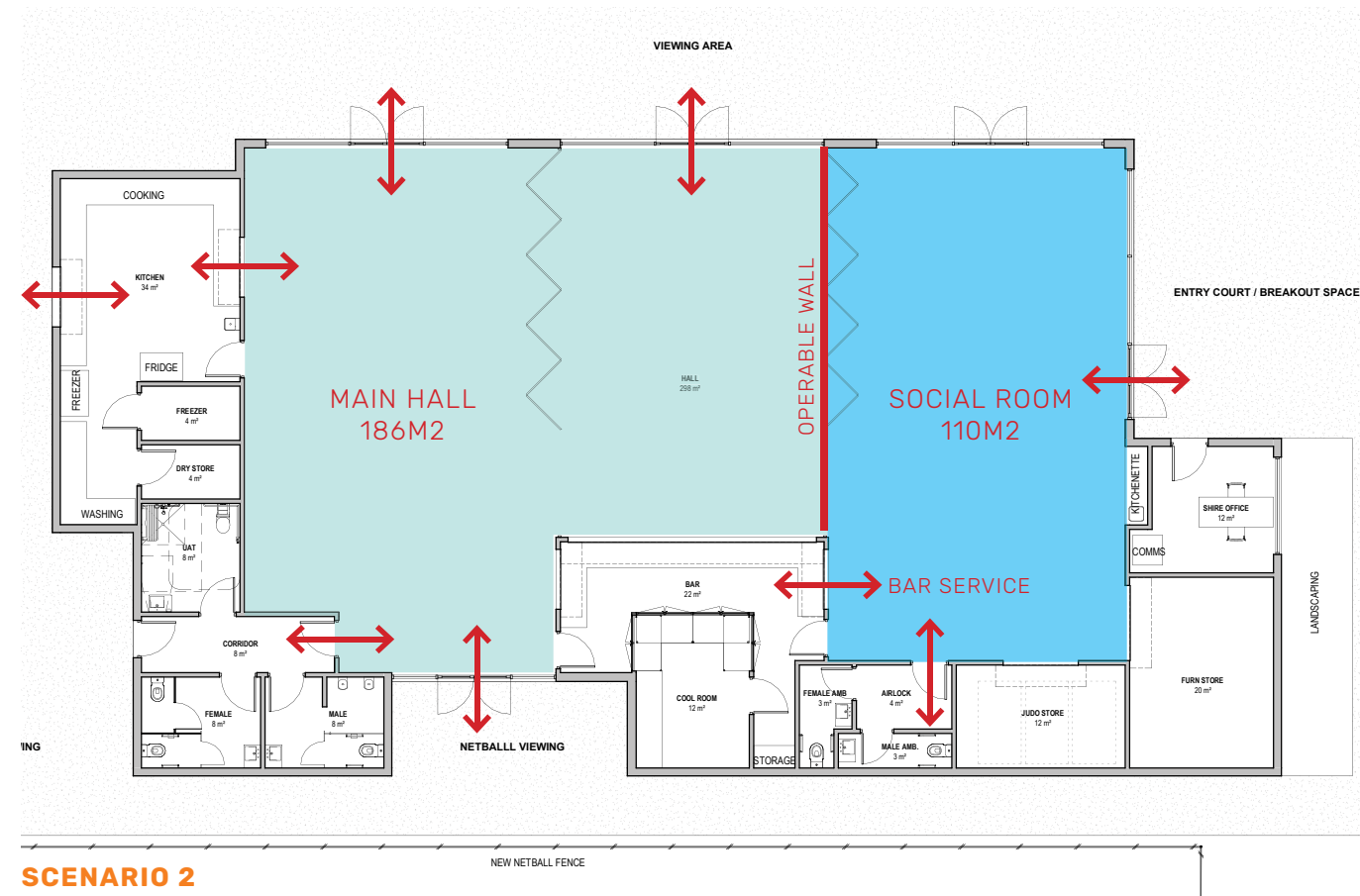
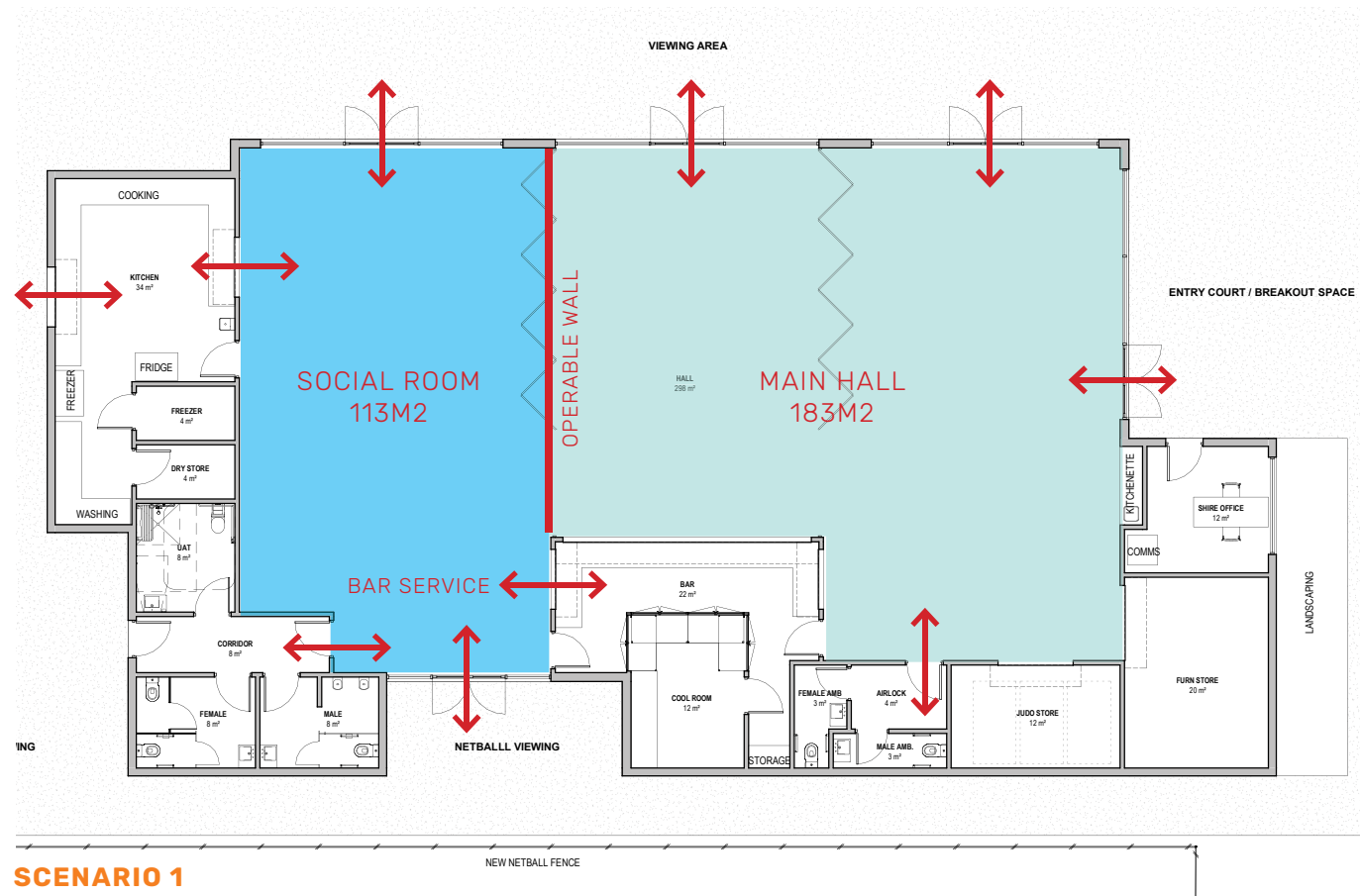

# 1.2 FUNCTION ARRANGEMENTS

28/09/21

REV C